



# Cross Keys Estates

Opening doors to your future



Cross Keys Estates

Residential Sales & Lettings



Cross Keys Estates  
Residential Sales & Lettings



Cross Keys Estates  
Residential Sales & Lettings

24 Victoria Place  
Plymouth, PL2 1BY  
Guide Price £375,000 Freehold



24 Victoria Place, Plymouth, PL2 1BY

Guide Price £375,000 Freehold

\*\* Guide Price £375,000 to £400,000 \*\*

Welcome to this stunning Georgian mid-terrace family home located in the highly desirable residential area of Victoria Place, Stoke, Plymouth. This immaculately presented property boasts an impressive grand hallway that sets the tone for the elegance found throughout the home.

With two spacious reception rooms, this house offers ample space for both relaxation and entertaining. The open plan sitting room is particularly inviting, providing a perfect setting for family gatherings or quiet evenings in. The property features six fantastic double bedrooms, each designed to offer comfort and style. The primary bedroom is especially noteworthy, with its expansive size and abundance of natural light to fill the room.

- Georgian Mid Terrace Family Home
- Six Fantastic Spacious Double Bedrooms
- Four Piece Luxury Bathroom & Downstairs Bathroom
- Private Enclosed Rear Garden
- Benefitting From A Garage
- Highly Desirable Residential Location
- Open Plan Sitting Room & Dining Room
- Large Modern Fitted Kitchen
- Close To Amenities, Stoke Village & Schools
- Early Viewing Advised, EPC-D60



## Cross Keys Estates

As one of Plymouth's leading QUALIFIED estate agents for over two decades, we are proud to have been offering our multi award winning customer service since day one. If you are currently on the market or you are thinking of putting your property on the market, why not give us a call, you will not be disappointed. 98% of our clients recommend us to their friends and family and our results, when it comes to sales, are unrivalled.

### Plymouth

Plymouth, Britain's Ocean City, is one of Europe's most vibrant waterfront cities. Located in one of the most beautiful locations imaginable, Plymouth is sandwiched between the incredible South West coastline and the wild beauty of Dartmoor National Park. Plymouth is 37 miles south-west of Exeter and 190 miles west-south-west of London, between the mouths of the rivers Plym to the east and Tamar to the west where they join Plymouth Sound to form the boundary with Cornwall, it is also home to one of the most natural harbours in the world. To the North of Plymouth is Dartmoor National Park, extending to over 300 square miles, which provides excellent recreational facilities.

The city is home to more than 260,000 people, making it the 30th most populated city in the United Kingdom and the second-largest city in the South West, after Bristol and has a full range of shopping, educational and sporting facilities. There is mainline train service to London (Paddington) and to Penzance in West Cornwall.

There's everything that you would expect to find in a cool, cultural city, with great shopping, arts and entertainment. But there's also hundreds of years of history to uncover, from Sir Francis Drake and the Spanish Armada to the Mayflower sailing in 1620, to a city rebuilt following the Blitz during World War II. With easy access to Exeter and its International Airport and a mainline train station giving direct access to London and a ferry port offering sea crossings to both France and Spain.

Plymouth is governed locally by Plymouth City Council and is represented nationally by three MPs. Plymouth's economy remains strongly influenced by shipbuilding and seafaring including ferry links to Brittany and Spain, but has tended toward a university economy since

### Stoke

The property is situated literally just a stone's throw away from the ever popular Stoke Village where a number of local amenities can be found. Stoke is well known for having an abundance of Victorian, Georgian and Edwardian properties within a conservation area. The area boasts easy access into Plymouth City Centre, which is only a short drive away and many local bus services run through the area giving access to all areas across Plymouth. Some of the amenities provided includes a co-operative store, pharmacy, cafe's, charity shops, public houses and much more. Primary schools in the area include Stoke Damerel Primary School and Stuart Road Primary School, whilst secondary schooling within the area includes Devonport High School for Boys and Stoke Damerel Community College. Plymouth College of Further Education is located on the southern fringes of the area, which is yet another added benefit along with being within close proximity to Devonport Dockyard and the Torpoint Ferry giving access in Cornwall. Located approximately 1 mile from Plymouth centre means that residents of stoke have easy access to Plymouth ferry port and within 3 miles of the A38. Plymouth Albion Rugby Football Club is located within a mile to the south west of Stoke with Plymouth Argyle Football Club located within a mile to the north east. There are a number of large recreational areas including the Block House Park, Victoria Park at Mill Bridge and Devonport Park within the area as well as the Ecological Park located south of Milehouse Road.

### More Property Information

The home also includes two well-appointed bathrooms, with the four-piece luxury bathroom providing a touch of opulence for your daily routines. Outside, you will find a private enclosed rear garden, ideal for enjoying the fresh air or hosting summer barbecues. Additionally, the property comes with a garage, offering convenient storage or parking options.

Situated close to local amenities and the charming Stoke Village, this property is perfect for families seeking a blend of modern living and traditional character. This home truly represents a wonderful opportunity to enjoy a comfortable lifestyle in a sought-after location. Don't miss your chance to make this exquisite property your own.

### Entrance Vestibule

3'11" x 4'11" (1.20m x 1.50m)

### Hallway

17'0" x 7'2" (5.17m x 2.19m)

### Sitting Room

13'2" x 15'0" (4.01m x 4.56m)

### Dining Room

13'0" x 12'8" (3.97m x 3.87m)

### Kitchen

15'9" x 10'10" (4.80m x 3.30m)

### Bathroom

8'1" x 10'10" (2.46m x 3.30m)

### Landing

27'6" x 6'7" (8.38m x 2.00m)

### Primary Bedroom

13'5" x 20'3" (4.09m x 6.17m)

### Bedroom 2

12'10" x 12'4" (3.90m x 3.76m)

### Family Bathroom

14'5" x 5'10" (4.39m x 1.78m)

### Bedroom 3

12'10" x 10'10" (3.90m x 3.30m)

### Landing

12'4" x 6'7" (3.77m x 2.00m)

### Bedroom 4

13'10" x 11'9" (4.22m x 3.59m)

### Bedroom 5

13'1" x 13'5" (4.00m x 4.10m)

### Bedroom 6

12'6" x 8'2" (3.80m x 2.48m)

### Garden

### Garage

### Cross Keys Estates Lettings Department

Cross Keys Estates also offer a professional, ARLA accredited Lettings and Management Service. If you are considering renting your property in order to purchase, are looking to buy to let or would like a free review of your current portfolio then please call our director Jack who is a fully qualified and award-winning letting agent on 01752 500018

### Financial Services



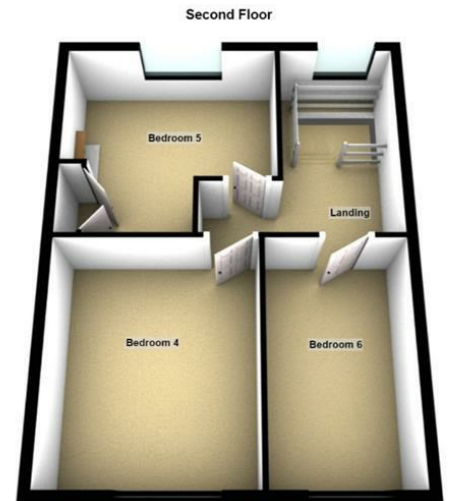
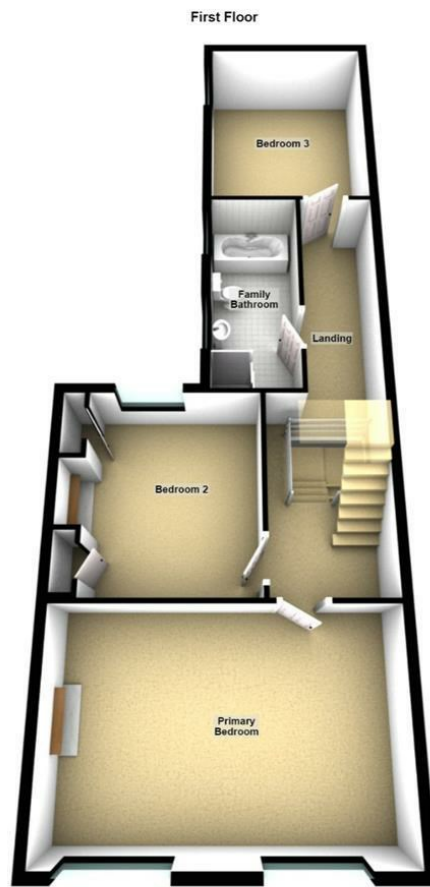
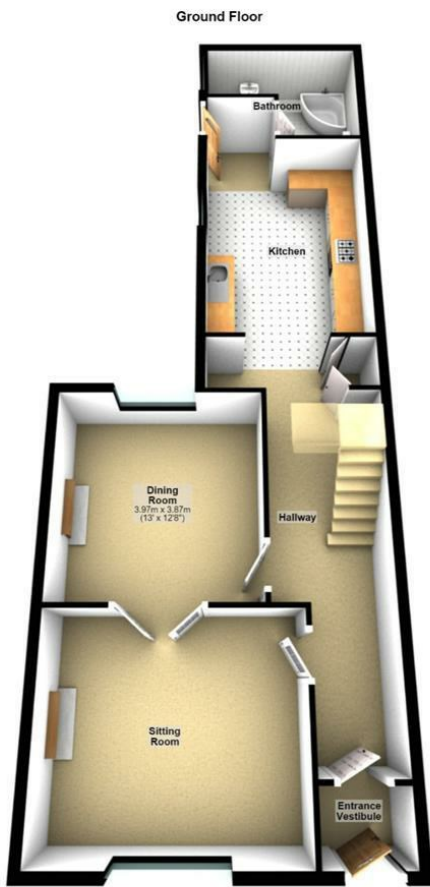

Energy Efficiency Rating		Current	Potential
Very energy efficient - lower running costs			
(92 plus) <b>A</b>			
(81-91) <b>B</b>			
(69-80) <b>C</b>			
(55-68) <b>D</b>			
(39-54) <b>E</b>			
(21-38) <b>F</b>			
(1-20) <b>G</b>			
Not energy efficient - higher running costs			
<b>England &amp; Wales</b>		EU Directive 2002/91/EC	

Environmental Impact (CO <sub>2</sub> ) Rating		Current	Potential
Very environmentally friendly - lower CO <sub>2</sub> emissions			
(92 plus) <b>A</b>			
(81-91) <b>B</b>			
(69-80) <b>C</b>			
(55-68) <b>D</b>			
(39-54) <b>E</b>			
(21-38) <b>F</b>			
(1-20) <b>G</b>			
Not environmentally friendly - higher CO <sub>2</sub> emissions			
<b>England &amp; Wales</b>		EU Directive 2002/91/EC	

VIEWINGS AND NEGOTIATIONS Strictly through the vendors agents, Cross Keys Estates MONEY LAUNDERING REGULATION 2003 AND PROCEEDS OF CRIME ACT 2002 Cross Keys Estates are fully committed to complying with The Money Laundering Regulations that have been introduced by the government. These regulations apply to everyone buying or selling a property, including companies, businesses and individuals within the United Kingdom or abroad. Should you either purchase or sell a property through this estate agents we will ask for information from you regarding your identity and proof of residence. We would ask for you to co-operate fully to ensure there is no delay in the sales/purchase process. IMPORTANT: we would like to inform prospective purchasers that these sales particulars have been prepared as a general guide only. A detailed survey has not been carried out, nor the services, appliances and fittings tested. Room sizes should not be relied upon for furnishing purposes and are approximate. If floor plans are included, they are for guidance only and illustration purposes only and may not be to scale. If there are any important matters likely to affect your decision to buy, please contact us before viewing the property.



**Council Tax Band C**



**Cross Keys Estates**  
Opening doors to your future

Sales, Cross Keys House 51-53 Devonport Road,,  
Stoke, Plymouth, Devon, PL3 4DL  
Tel: 01752 500018 | sales@crosskeysestates.net  
www.crosskeysestates.net